

David Kee



Toploader Transmissions, Inc.

David Kee Toploader Transmissions, Inc. specializes in Ford 4 speed toploader transmissions from 1964 to 1973. We are the world's largest manufacturer of high quality 4 speed toploader parts. We can remanufacture your toploader, sell you one outright or take yours in exchange. If you need parts for your toploader we can provide you with anything you need. We also sell 8" and 9" third members and parts, Lakewood bellhousings, Hurst shifters, McLeod clutches and bellhousings and Spicer drive shaft yokes. In addition, we are an authorized Jerico® Racing Transmission dealer.

This is your one stop 4 Speed Toploader shop.

Most of our parts are also available online. Visit our website at:
<http://www.davidkeetoploaders.com>.



18975 MARBACH LANE, STE. 1257
SAN ANTONIO, TEXAS 78266

ORDERS ONLY: 877-276-8081 / TECH LINE: 210-967-4161

EXPLODED VIEW OF A TOPLOADER

Use this picture to determine what parts you need. Refer to the information on the opposite page for part numbers and names.

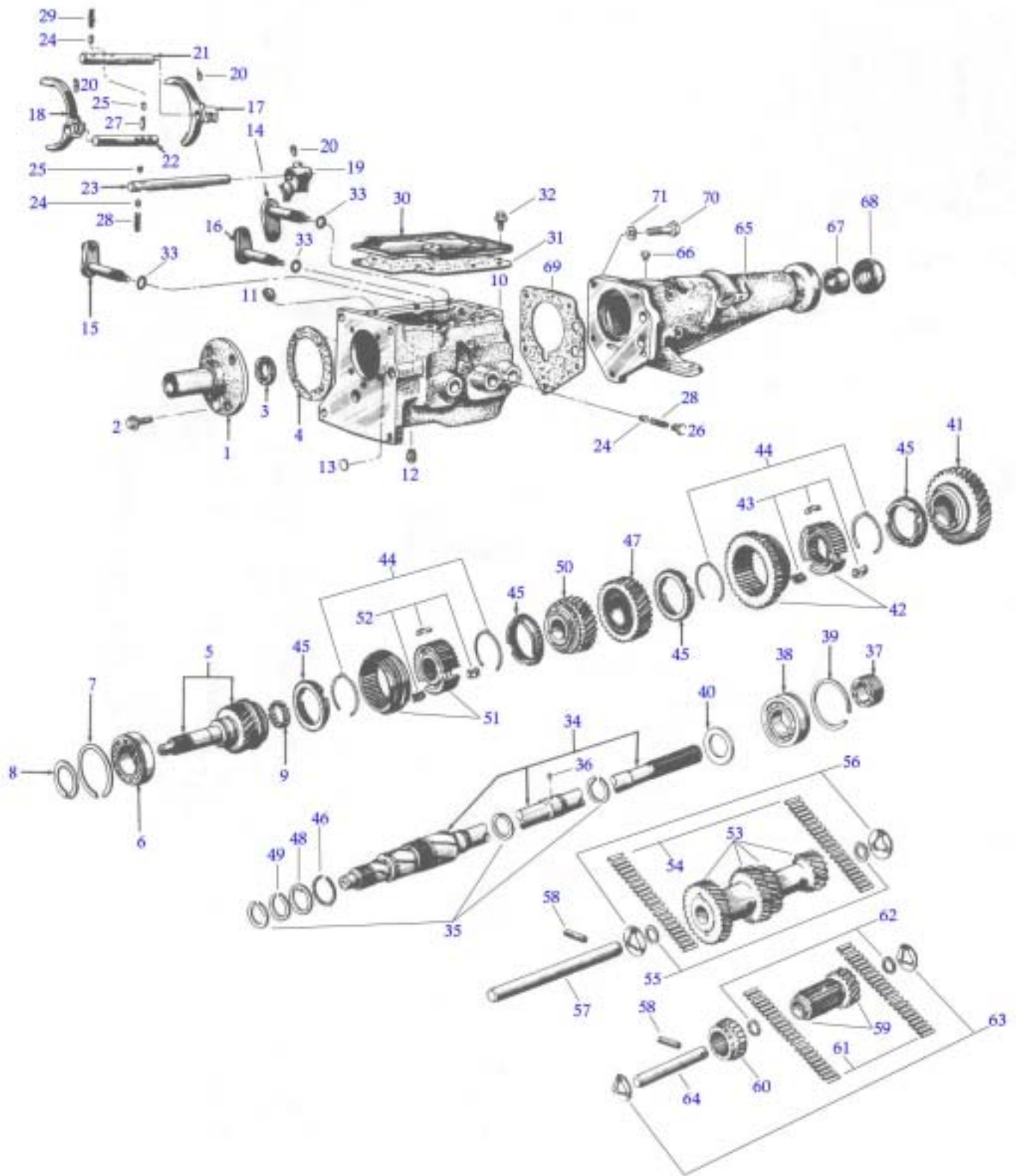

Number	Description	Part Number
1	Bearing Retainer	DK296-1 & 1A
2	Bolt	DK296-2
3	Front Seal	DK296-3 & 3A
4	Bearing Retainer Gasket	DK296-4
5	Input Shaft	DK296-5 thru 5C
6	Front Bearing	DK296-6 & 6A
7	Snap Ring (Bearing)	DK296-7
8	Snap Ring (Input Shaft)	DK296-8
9	Needle Bearings	DK296-9
10	Main Case	DK296-10
11	Fill Plug	DK296-11
12	Magnetic Drain Plug	DK296-12
13	Case Plug	DK296-13
14	1-2 Cam and Shaft	DK296-15
15	3-4 Cam and Shaft	DK296-15
16	Reverse Cam and Shaft	DK296-16
17	1-2 Shift Fork	DK296-17
18	3-4 Shift Fork	DK296-18
19	Reverse Fork	DK296-19
20	Set Screw	DK296-20
21	1-2 Shift Rail	DK296-21
22	3-4 Shift Rail	DK296-22
23	Reverse Shift Rail	DK296-23
24	Detents (Round)	DK296-24
25	Detents (Hatchet Head)	DK296-25
26	Bolt (Side Detent)	DK296-26
27	Interlock Pin	DK296-27
28	Detent Spring (Short)	DK296-28
29	Detent Spring (Long)	DK296-29
30	Top Cover	DK296-30
31	Top Cover Gasket	DK296-31
32	Bolt (Top Cover)	DK296-32
33	O-Ring	DK296-33
34	Mainshaft	DK296-34C & 34E
35	Snap Ring	DK296-35
36	Steel Ball	DK296-36

Number	Description	Part Number
37	Speedometer Drive Gear	page 5
38	Rear Bearing	DK296-38 & 38A
39	Snap Ring (Rear Bearing)	DK296-39
40	Thrust Washer (First Gear)	DK296-40
41	First Gear	DK296-41
42	1-2 Synchronizer Assembly	DK296-42
43	1-2 Synchronizer Keys	DK296-43
44	C-Spring	DK296-44
45	Bronze Blocker Ring	DK296-45
46	Snap Ring	DK296-46
47	Second Gear	DK296-47 & 47A
48	Thrust Washer	DK296-48
49	Snap Ring	DK296-49
50	Third Gear	DK296-50 & 50A
51	3-4 Synchronizer Assembly	DK296-51
52	3-4 Synchronizer Keys	DK296-52
53	Cluster Gear	DK296-53 & 53A
54	Needle Bearings	DK296-54
55	Needle Bearing Retainers	DK296-55
56	Metallic Thrust Washer	DK296-56
57	Counter Shaft	DK296-57
58	Roll Pin	DK296-58
59	Rear Reverse Idler Gear	DK296-59
60	Reverse Idler Gear (Slider)	DK296-60
61	Needle Bearing	DK296-61
62	Needle Bearing Retainer	DK296-62
63	Metallic Thrust Washer	DK296-63
64	Reverse Counter Shaft	DK296-64
65	Tailhousing	DK296-65
66	Air Vent	DK296-66
67	Bushing	DK296-67
68	Seal	DK296-68
69	Gasket	DK296-69
70	Bolts (Tailhousing)	DK296-70
71	Lock Washers	DK296-71

Contents

DKT Maincase	1
DKT Tailhousing	1
Rebuild Kits	2
SKF Main Bearings	3
Bearing Retainers	3
Synchronizer Assemblies	3
Close Ratio Gears	3
Wide Ratio Gears	4
Mainshafts	4
Counter Shafts	4
Bushings	5
Reverse Gear	5
Speedometer Gears	5
Shift Forks	5
Shift Rail Kit	6
Top Cover	6
Transmission Mounts	6
Gaskets	6
Top Cover	6
Plastic Plugs	6
Bolts	7
Seals	7
Transmission Yokes	7
Shift Cam and Shafts	7
Blocker Rings	7
Snap Ring	7
Apparel	8
Cobra Shifters	8
Hurst Competition Plus Shifters	8
Bellhousings	8
Flywheels	9
McLeod Street/Dual Performance Clutches	9
Clutch Forks	10
Pilot Bushings	10
Throwout Bearings	10
Third Members	11
Payment and Shipping Information	12

To order a new transmission, or to have your transmission rebuilt, please contact us.

DKT MAINCASE



Our new nodular iron wide bolt pattern maincase will be available soon. Every case will have a drain plug hole. To pre-order a maincase, please contact us **DK296-10**

DKT TAILHOUSING

We have manufactured a new iron nodular iron tailhousing that replaces C4D, C4Z, C6O, and C7O casting numbers and has the correct shifter locations for:

- 1964-65 Falcon
- 1964-73 Mustang, Cougar
- 1966-68 Fairlane, Cyclone, Ranchero, Torino 289, 302, 390
- 1966-69 Falcon 289, 302
- 1966-69 Mustang, Cougar 390
- 1967 up Fairlane, Cyclone 427, 428
- 1968-69 Mustang 428, 429

This will allow you to use your toploader in different model vehicles without having to find a different tailhousing to move the shifter to the right location. Our tailhousing is available in 28 or 31 spline output shaft size. **DK296-65**



We have decided to manufacture the DKT maincase and tailhousing in aluminum. If you are interested in an aluminum toploader please contact us.

REBUILD KITS

All of our kits are professionally packed and ready for immediate delivery. We also offer our Top Cover to all kit purchasers for an additional \$10 (a \$19.99 value).

MASTER REBUILD KIT



Master rebuild kit with standard duty SKF bearings used to rebuild any 4 speed toploader. Available in any shaft size configuration. Kit contains: all needle bearings, snap rings, thrust washers, spacers, speedometer ball, dowel pins, case plug, shift lever o-rings, front and rear seal, gasket set, C springs, new magnetic drain plug, air vent, counter shaft, 4 bronze original equipment blocker rings, front & rear main bearings, synchronizer keys, tailshaft bushing and instructions. Please specify shaft sizes when ordering **DK296M-STD**

MASTER REBUILD KIT PLUS



This kit contains everything in the Master Rebuild Kit, plus assembly lube and cast blast paint. Can only be shipped by ground service. Please specify shaft sizes when ordering **DK296M-PLUS**

ROAD RACE KIT



This kit contains all needle bearings, snap rings, thrust washers, spacers, speedometer ball, dowel pins, case plug, shift lever o-rings, front and rear seal, gasket set, C springs, new magnetic drain plug, air vent, 3 shift rail set screws, counter shaft, 4 bronze original equipment blocker rings, Max type SKF front & rear main bearings, synchronizer keys and tailshaft bushing. Please specify shaft sizes when ordering. **DK296MA**

ROAD RACE KIT PLUS



This kit contains everything in the Road Race Kit, plus assembly lube and cast blast paint. Can only be shipped by ground service. Please specify shaft sizes when ordering. **DK296MP-MAX**

SMALL REBUILD KIT



This kit contains all needle bearings, snap rings, thrust washers, spacers, speedometer ball, dowel pins, case plug, shift lever o-rings, front and rear seal, gasket set and synchronizer C-springs. Please specify shaft sizes when ordering. **DK296-SRK**

SMALL PARTS KIT



This kit includes all needle bearings, snap rings, thrust washers, spacers, speedometer ball, dowel pins. **DK296-SPK**

SEAL AND GASKET KIT



This kit contains all gaskets, front and rear seal, three shift lever o-rings, rear bushing and case plug. Please specify shaft sizes when ordering. **DK296SK**

SKF MAIN BEARINGS



Standard Duty Input Bearing **DK296-6**
 Standard Duty Output Bearing **DK296-38**

Max Duty Input Bearing **DK296-6A**
 Max Duty Output Bearing **DK296-38A**

BEARING RETAINERS



1-1/16" **DK296-1**
 New seal and gasket included. Order 4 11/16" for 1964 4 hole cases and 4 7/8" for 1965-73 8 hole cases.



1-3/8" **DK296-1A**
 New seal and gasket included. Order 4 11/16" for 1964 4 hole cases and 4 7/8" for 1965-73 8 hole cases.

SYNCHRONIZER ASSEMBLIES



Torque lock design. Inner and outer hubs are a matched set with new dogs and C-springs. Also available with bronze rings for an additional \$20.

- 1-2 Assembly **DK296-42**
- 3-4 Assembly **DK296-51**
- Original Design Synchronizer C-Spring **DK296-44**
- 1-2 Synchronizer Key **DK296-43**
- 3-4 Synchronizer Key **DK296-52**

CLOSE RATIO GEARS



- First Gear 32 Tooth **DK296-41**
- Second Gear 28 Tooth **DK296-47**
- Third Gear 25 Tooth **DK296-50**
- Cluster Gear **DK296-53**



Fourth Gear 1-1/16" One Piece Small Input **DK296-5**

This is our new 1 1/16 inch close ratio 4th gear. Use this gear as a direct replacement for any small input close ratio toploader. This input is one piece just like the originals.

Fourth Gear 1 3/8" One Piece Big Input **DK296-5A**

This is our new 1 3/8 inch close ratio 4th gear. Use this gear to convert any close ratio toploader to a large input unit or use it as a direct replacement for any large input close ratio toploader. This input is one piece just like the originals.



Close Ratio Gear Set, Small Input **DK296-CGSA**
 Includes: 2nd, 3rd, 1 1/16 inch input shaft and cluster gear. Use this gear set to replace a worn gear set or convert a wide ratio to a small input close ratio toploader.

Close Ratio Gear Set, Big Input **DK296-CGS**
 Includes: 2nd, 3rd, 1 3/8 inch input shaft and cluster gear. Use this gear set to replace a worn gear set or convert a wide ratio to a big input close ratio toploader.

WIDE RATIO GEARS



- First Gear 32 Tooth **DK296-41**
- Second Gear 31 Tooth **DK296-47A**
- Third Gear 25 Tooth **DK296-50A**
- Cluster Gear **DK296-53A**

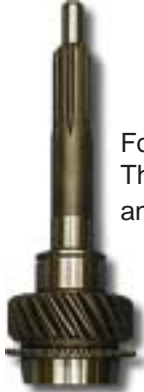

Fourth Gear 1-1/16" One Piece Small Input **DK296-5B**
 This is our new 1 1/16 inch wide ratio 4th gear. Use this gear as a direct replacement for any small input wide ratio toplayer. This input is one piece just like the originals.

Fourth Gear 1 3/8" One Piece Big Input **DK296-5C**
 This is our new 1 3/8 inch wide ratio 4th gear. Use this gear to convert any wide ratio toplayer to a large input unit. This input is one piece just like the originals.



Wide Ratio Gear Set, Small Input **DK296-WGSA**
 Includes: 2nd, 3rd, 1 1/16 inch input shaft and cluster gear. Use this gear set to replace a worn gear set or convert a close ratio to a small input wide ratio toplayer.

Wide Ratio Gear Set, Big Input **DK296-WGS**
 Includes: 2nd, 3rd, 1 3/8 inch input shaft and cluster gear. Use this gear set to replace a worn gear set or convert a close ratio to a big input wide ratio toplayer.

MAINSHAFTS



24" x 28 spline **DK296-34C**

Fits all small block Mustang, Cougar, Fairlane, Falcon, Comet, Ranchero, Boss 302 and Shelby GT 350 Toploaders. This is our own design mainshaft with OEM type oiling passages.



24" x 31 spline **DK296-34E**

Fits all big block Mustang, Cougar, Fairlane, GT 500 and 427 Cobra Toploaders. This is our own design mainshaft with OEM type oiling passages and larger outside diameter from the back of the rear bearing to the output splines.

27" x 31 spline Torino, big block Galaxie *Call*

27" x 28 spline small block Galaxie, 289 Cobra *Call*

25-1/2" x 28 spline Sunbeam Tiger *Call*

COUNTER SHAFTS



Cluster Gear Counter Shaft **DK296-57**

This is the counter shaft that goes through the main cluster gear. Also known as lay shaft.



Reverse Counter Shaft **DK296-64**

This is the counter shaft that goes through the reverse cluster gear. Also known as lay shaft.

BUSHINGS

28 Spline Tailhousing Bushing	DK296-67
31 Spline Tailhousing Bushing	DK296-67A

REVERSE GEARS



Reverse Spur Gear	DK296-60
This is the straight cut gear that slides forward to engage reverse.	
Reverse Idler Gear	DK296-59

SPEEDOMETER GEARS



Black 7 Tooth Speedometer Drive Gear	C4DZ-17285A
Fits all 64-73 toploaders except Galaxie, 64 Fairlane and Sunbeam Tiger. This speedometer gear is most commonly used on cars with 2.80 to 3.50 rearend gears.	
Pink 6 Tooth Speedometer Drive Gear	C5ZZ-17285A
Fits all 64-73 toploaders except Galaxie, 64 Fairlane and Sunbeam Tiger. This speedometer gear is most commonly used on cars with 3.50 to 4.11 rearend gears.	
16 Tooth Driven Gear	16T
17 Tooth Driven Gear	17T
19 Tooth Driven Gear	19T
20 Tooth Driven Gear	20T
Green 6 Tooth Speedometer Drive Gear	DK296-GSG
Used for Galaxie, Sunbeam Tiger and 64 Fairlane	
Yellow 7 Tooth Speedometer Drive Gear	DK296-YSG
Used in Toploaders in Galaxie, 64 Fairlane and Sunbeam Tiger with speedometer hole on drivers side. This gear is most commonly used on cars with 3.00 to 3.50 rearend gears.	
Brown 8 Tooth Speedometer Drive Gear	DK296-BSG
Used in Toploaders in Galaxie, 64 Fairlane and Sunbeam Tiger with speedometer hole on drivers side. This gear is most commonly used on cars with 3.00 and higher rearend gears.	
16 Tooth Driven Gear, RH	16TR
17 Tooth Driven Gear, RH	17TR
18 Tooth Driven Gear, RH	18TR
19 Tooth Driven Gear, RH	19TR
20 Tooth Driven Gear, RH	20TR
21 Tooth Driven Gear, RH	21TR

SHIFT FORKS



1-2 Shift Fork	DK296-17
Fits all 64-73 toploaders	
3-4 Shift Fork	DK296-18
Fits all 64-73 toploaders	
Reverse Shift Fork	DK296-19

SHIFT RAIL KIT



Shift Rail Kit **DK296-RK**

Includes: all three shift rails, interlock pin, 3 round head detents, 2 hatchet head detents.

Interlock Pin **DK296-27**

We have manufactured all of the interlock pins available for a toploader. If you have lost the interlock pin or have the wrong one, call us - we have them in stock. *Please do not run your toploader without the interlock pin.*

TRANSMISSION MOUNTS

 Stock Replacement **DK296-CM**

Fits small block and big block Mustang, small block and big block Cougar, all 66-70 Falcon, all 66-up Fairlane, all Torino. Fits tailhousing casting numbers DKT, C4D, C4Z, C6O, C7O, D0Z, C9O.

 High Performance Polyurethane **DK296-PCM**

Fits big block Mustang, big block Cougar, all 66-70 Falcon, all 66-up Fairlane and all Torino. Fits tailhousing casting numbers DKT, C6O, C7O, DOZ and C9O.

GASKETS

 Bearing Retainer Gasket **DK296-4**

Tailhousing Gasket **DK296-69**

Top Cover Gasket **DK296-31**

Complete Toploader Gasket Set **DK296-GS**

TOP COVER

 Top Cover **DK296-30**

Our top cover is made with the same contour around the bolt holes as the original toploader lids. Available with or without air vent hole.

PLASTIC PLUGS

 28 Spline Plug **28PL**

Plastic plug for all 28 spline toploaders. This plug will allow you to fill the transmission with gear lube before it is installed.

 31 Spline Plug **31PL**

Plastic plug for all 31 spline toploaders. This plug will allow you to fill the transmission with gear lube before it is installed.

 Speedometer Cable Hole Plug **SPPL**

Plastic plug for speedometer cable hole in tailhousing. This plug will allow you to fill the transmission with gear lube before it is installed.



BOLTS

Top Cover Bolt	DK296-32
Grade 8 Transmission Mounting Bolt with Lock Washer	TMB
ARP Flywheel Bolt	FWB
Metric Pressure Plate Bolt	MPP
ARP Pressure Plate Bolt	PPB
Shift Rail Set Screw	DK296-20
Tailhousing Bolt	DK296-70
Tailhousing Bolt Lock Washer	DK296-71



SEALS

Shift Lever O-Ring	DK296-33
1 1/16" Input Shaft Seal	DK296-3
1 3/8" Input Shaft Seal	DK296-3A
28 Spline Rear Seal	DK296-68
31 Spline Rear Seal	DK296-68A
Case Plug	DK296-13

TRANSMISSION YOKES

 28 Spline x 1310 Slip Yoke	28-1310
 28 Spline x 1330 Slip Yoke	28-1330
 31 Spline x 1330 Slip Yoke	31-1330

SHIFT CAM AND SHAFTS

 1-2 and 3-4 Shift Cam and Shaft	DK296-15
This is our new cam and shaft for 1-2 and 3-4. It is available exclusively at DKT. The pin that engages the fork is permanent so you will not have to worry about it coming loose.	
 Reverse Shift Cam and Shaft	DK296-16
This is our new cam and shaft for reverse. It is available exclusively at DKT. The pin that engages the fork is permanent so you will not have to worry about it coming loose.	

BLOCKER RINGS

 OEM Type Bronze Blocker Ring	DK296-45
This is the ring that was used in toploaders back in the 70's. It is a high quality bronze blocker ring that is strong enough to resist distortion without being brittle.	

SNAP RING

For speedometer gear, rear bearing and 3-4 synchronizer	DK296-35
---	-----------------

APPAREL



DKTT T-shirts	
Large, X-Large (available in white or gray)	T-Shirt
XX-Large	T-Shirt
DKTT Sweatshirts	
Large, X-Large	Sweatshirt
XX-Large	Sweatshirt

COBRA SHIFTERS



Fits tailhousing casting numbers C4A, C6A, and C4O **HUU-289COBRA**



Fits tailhousing casting numbers DKT, C6O, C7O, C9O, D0Z, C4Z and C4D **HUU-427COBRA**

Cobra Shift Boot and Trim Ring **HUU-COBRABOOT**
 Included with every Cobra Shifter, but may be purchased separately

HURST COMPETITION PLUS SHIFTERS

We sell our Hurst shifters complete with installation kit and instructions. Shifter prices include white knob, chrome handle, mounting hardware, all linkage rods and levers. Our Hurst shifters are not modified in any way and have the full Hurst factory warranty

1964-65 Galaxie	HUU-C4AG
Pickup Truck Series	HUU-C4APTS
1964-73 Mustang 289-302-351, 1967-69 Cougar 289-302-351	HUU-C4ZM
1964-65 Comet, Falcon	HUU-C4DF
1966-71 Fairlane	HUU-C7OF
1967-73 Mustang 390-428-429, 1967-69 Cougar 390-428-429	
1972-73 Fairlane, Torino, Ranchero	HUU-C7OM
Hurst Boot and Trim Ring for Competition Plus Shifters	HUU-BOOT
Hurst Reverse Light Switch	HUU-REVSW
1972-71 Ford/Hurst T-handle with set screw and jam nut	70-71 T-HANDLE
Hurst linkage bushing for OEM Shifter	HUU-OEMBUSHING
Replacement steel pushings and spring clips	HUU-PITPACK

BELLHOUSINGS



289-302-351 McLeod Bellhousing	MCL289-351
1962-03 260, 289, 302, 351 (157 tooth 164 tooth flywheel) McLeod Modular Bellhousing ..	MCL-M289
1958-74 FE Big Block (184 tooth flywheel) McLeod Modular Bellhousing	MCL-M427
1969-02 429, 460, 351M, 400 (176 180 tooth flywheel) McLeod Modular Bellhousing	MCL-M429
289-302-351 Lakewood Bellhousing	LAK289-351
390-427-428 Lakewood Bellhousing	LAK390-428
429-460 Lakewood Bellhousing	LAK429-460
Bellhousing Clutch Fork Pivot, for 1968 and newer forks	BFP

FLYWHEELS

~~289-351~~

260-289 Engine, 0 Balance	4100
260-302 Steel Flywheel, 157 Tooth	4100-28
289-351 Steel Flywheel, 164 Tooth, 0 Balance	4200
289-351 Steel Flywheel, 164 Tooth	4200-28
1980-95 302 Steel Flywheel, 50 oz Counter Balance	4200-50
289-351 Aluminum Flywheel, 157 Tooth, 28 oz Balance	5100-28
289-351 Aluminum Flywheel, 164 Tooth, 28 oz Counter Balance	5200-28

~~360-390-427~~

332-427 34 40# Steel Flywheel 0 Balance	4210
332-427 25# Steel Flywheel 0 Balance	4215
332-427 Aluminum Flywheel 0 Balance	5210

~~428~~

428 34-40# Steel Flywheel with 28 oz Counter Balance	4210-28
428 28-33# Steel Flywheel with 28 oz Counter Balance	4215-28

~~429-460~~

429-460 40# Steel Flywheel 0 Balance	4220
429-460 25# Steel Flywheel 0 Balance	4222
429-460 Aluminum Flywheel 0 Balance	5220

MCLEOD STREET/DUAL PERFORMANCE CLUTCHES



~~260-289-302~~

Original type and size 10 1/2" diameter 1 1/16" x 10 spline street clutch disc with organic facing on both sides	MCL-2230
Original type and size 10" diameter 1/16" x 10 spline street clutch disc with organic facing on both sides	MCL-2236
10 1/2" diameter 1 1/16" x 10 spline dual performance clutch disc with Kevlar facing on flywheel side and organic facing on pressure plate side	MCL-2830
10" diameter x 10 spline dual performance clutch disc with Kevlar facing on flywheel side and organic facing on pressure plate side	MCL-2836
Original type 10" diameter 1 1/16" x 10 spline diaphragm pressure plate	MCL-3030
10 1/2" diameter x 10 spline long style performance pressure plate	MCL-3400
Original type 10 1/2" diameter 1 1/16" x 10 spline long style pressure plate	MCL-3401
Original type 10 1/2" diameter 1 1/16" x 10 spline long style pressure plate specially designed for Sunbeam Tigers	MCL-3406

351-390

Original type and size 11" diameter 1 1/16" x 10 spline street clutch disc with organic facing on both sides of disc	MCL-2231
11" diameter 1 1/16" x 10 spline dual performance clutch disc with Kevlar facing on flywheel side and organic facing on pressure plate side	MCL-2831
11" diameter 1 1/16" x 10 spline long style performance pressure plate	MCL-3500
11" diameter 1 1/16" x 10 spline long style street pressure plate	MCL-3501
11" diameter 1 1/16" x 10 spline diaphragm type pressure plate	MCL-3850

390 GT

12" diameter 1 1/16" x 10 spline street clutch disc with organic facing on both sides. This 12" disc is designed to replace the original 11 1/2" disc	MCL-2233
12" diameter 1 1/16" x 10 spline dual performance clutch disc with Kevlar facing on flywheel side and organic facing on pressure plate side. This 12" disc is designed to replace the original 11 1/2" disc	MCL-2833
12" diameter 1 1/16" x 10 spline diaphragm type pressure plate. This pressure plate is designed to replace the original 11 1/2" unit and uses the same bolt pattern	MCL-3821

427-428-429

11 1/2" diameter 1 3/8" x 10 spline street clutch disc with organic facing on both sides	MCL-2262
12" diameter 1 3/8" x 10 spline street disc with organic facing on both sides. This 12" clutch disc is designed to replace the original 11 1/2" disc	MCL-2263
McLeod 12" diameter clutch disc with 1 1/8" x 26 spline for Tremec TKO II	MCL-2273
12" diameter 1 3/8" x 10 spline dual performance disc with Kevlar facing on flywheel side and organic facing on pressure plate side. This 12" clutch disc is designed to replace the original 11 1/2" disc	MCL-2863
McLeod 12" diameter dual performance clutch disc with 1 1/8" x 26 spline for Tremec TKO II	MCL-2873
12" diameter long style performance pressure plate. This pressure plate is designed to replace the original 11 1/2" unit and uses the same bolt pattern	MCL-3650
12" diameter long style street pressure plate. This pressure plate is designed to replace the original 11 1/2" unit and uses the same bolt pattern	MCL-3651
12" diameter 1 3/8" x 10 spline diaphragm type pressure plate. This pressure plate is designed to replace the original 11 1/2" unit and uses the same bolt pattern. Throwout bearing is included with this unit	MCL-3825

CLUTCH FORKS

Small Block Clutch Fork for 1968 and newer 289-302-351	C8OZ-7515-A
Big Block Clutch Fork for 1 3/8" x 10 input shaft toploaders	C8OZ-7515-D
Bellhousing Clutch Fork Pivot for 1968 and newer forks	BFP
Tremec TKO II Clutch Fork	TKOF

PILOT BUSHINGS

Small Block Crankshaft Pilot Bushing	PB289
Big Block Crankshaft Pilot Bushing	PB427

THROWOUT BEARINGS

Hydraulic Throwout Bearing	1304
1 1/16" Bolt On Hydraulic Throwout Bearing	13045
1 3/8" Bolt On Hydraulic Throwout Bearing	1305
1 3/8" Bolt On Hydraulic Throwout Bearing with Master Cylinder	13055
McLeod 1 1/16" Throwout Bearing	16031
McLeod 1 3/8" Throwout Bearing	16042

THIRD MEMBERS

We are warehouse distributors for Currie Enterprises and Precision Gear. Our 9" third members are professionally set up with new ring and pinions, Timken bearings and National oil seals.



COMPLETE FORD 9" THIRD MEMBERS

3.00, 3.25, 3.50, 3.70, 3.89, 4.11, 4.30, OR 4.57 RATIO

9	300	DL	28
9" Prefix	Ratio	Differential	Spline

Part numbers are determined by ring gear size, gear ratio and differential. For example, the number to the left designates 9" Third Member with a gear ratio of 3.00, Detroit Locker differential and spline of 28. Please refer to the Product Price Guide for a list of all Complete Ford 9" Third Members.

9" THIRD MEMBER PARTS

Detroit Truetrac 28 spline	5038
Detroit Truetrac 31 spline	5024
Detroit Locker 28 spline	5004
Detroit Locker 31 spline	5003
Traction-Lok 28 spline	9-TL28
Traction-Lok 31 spline	9-TL31
Clutch Pack Kit	9-5014
Strange 9" Case	4028
Daytona pinion support	4031C
Ford Motorsport Friction Modifier	5012
9" third member installation kit: 3 quarts Torco 85-140w, GL-6 rated oil, 10 nylock nuts, 10 washers and gasket	9-INSKIT

9" RING & PINION SETS

3.00	9-300	3.89	9-389
3.25	9-325	4.11	9-411
3.50	9-350	4.30	9-430
3.70	9-370	4.57	9-457

COMPLETE FORD 8" THIRD MEMBERS

3.00, 3.25, 3.55, 3.80 OR 4.11 RATIO

Part numbers are determined by ring gear size, gear ratio and differential. For example, the number to the right designates an 8" Third Member with a gear ratio of 3.00 and a torque sensing differential. Please refer to the Product Price Guide for a list of all Complete Ford 8" Third Members.

8	300	TSD
8" Prefix	Ratio	Differential

METHOD OF PAYMENT

Payment must be made by MasterCard, Visa, Discover, American Express, money order or certified check.

SHIPPING INFORMATION

Orders are usually shipped within one business day. We use UPS Ground for shipping, unless otherwise specified by the customer.

The map below illustrates the number of transit days for delivery via UPS Ground services to anywhere within the continental United States from our location in San Antonio, Texas.

